

TM 11/1796

PLANNING  
TRANSPORT & LEISURE  
Tonbridge & Malling B.C.  
04 JUL 2011

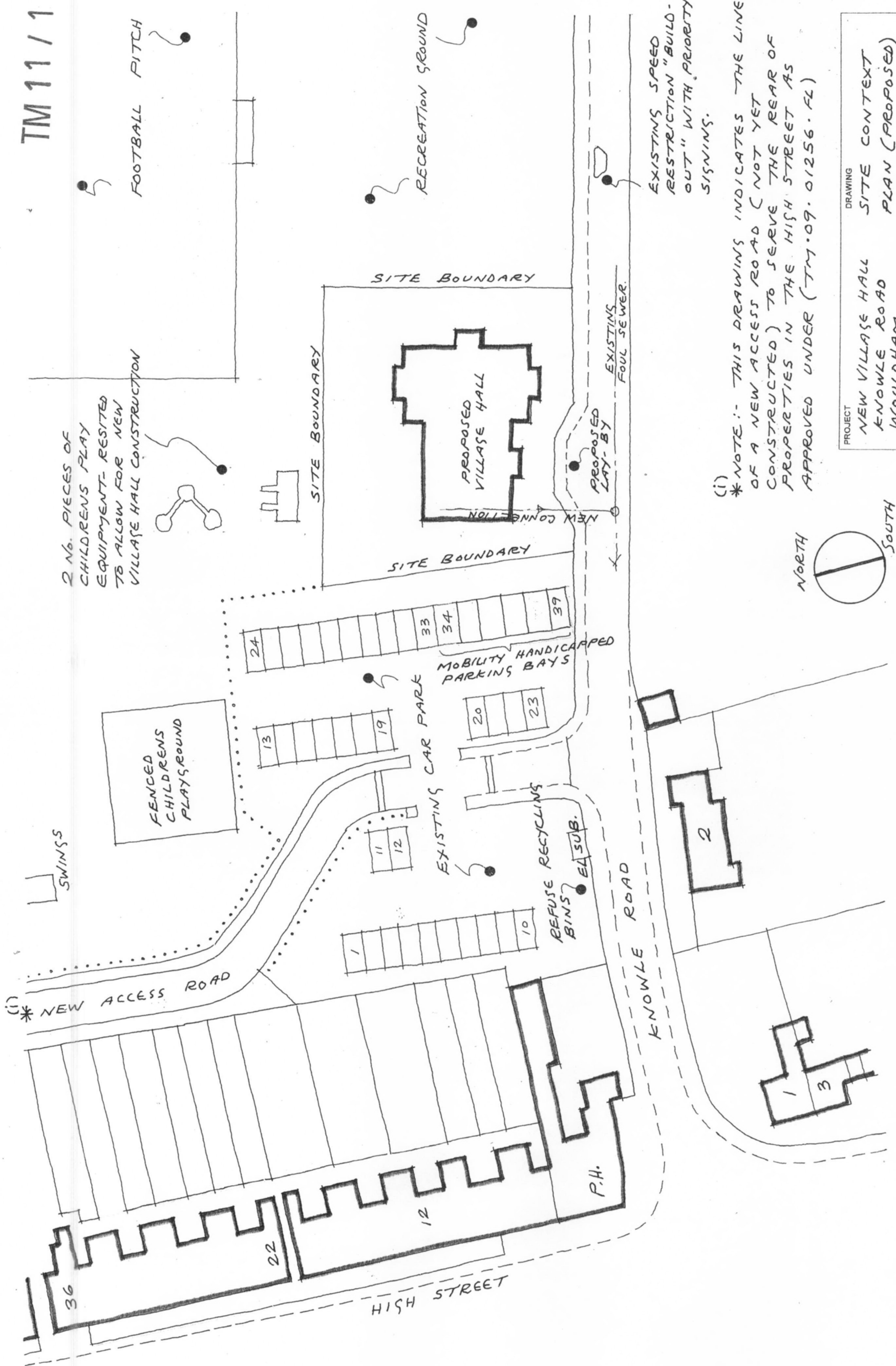

2 NO. PIECES OF CHILDRENS PLAY EQUIPMENT- RESITED TO ALLOW FOR NEW VILLAGE HALL CONSTRUCTION

(i) \*NOTE:- THIS DRAWING INDICATES THE LINE OF A NEW ACCESS ROAD (NOT YET CONSTRUCTED) TO SERVE THE REAR OF PROPERTIES IN THE HIGH STREET AS APPROVED UNDER (TM.09.01256.FL)

PROJECT  
DRAWING  
NEW VILLAGE HALL  
KNOWLE ROAD  
WOULDHAM  
SITE CONTEXT  
PLAN (PROPOSED)

LLOYD HUNT ASSOCIATES

Chartered Architects  
Camelot, Pescot Avenue, Longfield, Kent DA3 7NA  
Tel: (01474) 702274 Fax: (01474) 702219 Email: lloydhunt@btinternet.com

DRAWN  
DATE  
SCALE  
REV  
DATE

MEH 8.06.2011 1:500 P.J.2271